

SERVICE & WARRANTY INFORMATION

How to Get Service Under the Terms of the Limited One-Year Warranty

For warranty repair, do not return your product to the place of purchase. Instead, follow the instructions below to obtain warranty service as our dealer network is not prepared to service the product under the terms of this warranty.

- First, write, call, e-mail, or FAX M.T.H. Electric Trains®, 7020 Columbia Gateway Drive, Columbia, MD 21046 (Tel.: 410.381.2580; e-mail: service@mth-railking.com; FAX: 410.381.6122), stating when it was purchased and what seems to be the problem. You will be given a return authorization number to assure that your merchandise will be properly handled upon its receipt.
- **CAUTION: Make sure the product in its original factory packaging including its foam and plastic wrapping material so as to prevent damage to the merchandise. The shipment must be prepaid and we recommend that it be insured.** A cover letter including your name, address, daytime telephone number, e-mail address (if available), Return Authorization number, a copy of your sales receipt, and a full description of the problem must be included to facilitate the repairs. Please include the description regardless of whether you discussed the problem with one of our service technicians when contacting M.T.H.® for your Return Authorization Number.
- **Please make sure you have followed the instructions carefully before returning any merchandise for service.**

Limited One-Year Warranty

All M.T.H.® products purchased from an Authorized M.T.H. Train Merchant are covered by this warranty.

See our website at www.mth-railking.com or call 1.888.640.3700 to identify an Authorized M.T.H. Train Merchant near you.

M.T.H. products are warranted for one year from the date of purchase against defects in material or workmanship, excluding light bulbs and traction tires. We will repair or replace (at our option) the defective part without charge for the parts or labor, if the item is returned to M.T.H. Electric Trains® within one year of the original date of purchase. This warranty does not cover damages caused by improper care, handling, or use. Transportation costs incurred by the customer are not covered under this warranty.

Items sent for repair must be accompanied by a return authorization number, a description of the problem, and **a copy of the original sales receipt from an Authorized M.T.H. Train Merchant**, which gives the date of purchase. Call 410.381.2580, fax 410.423.0009, or e-mail the Service Department at service@mth-railking.com to obtain a return authorization number.

This warranty gives you specific legal rights, and you may have other rights that vary from state to state.

Service Department
M.T.H. Electric Trains®
7020 Columbia Gateway Drive
Columbia, MD 21046-1532



www.mth-railking.com

RAIL KING
By MTH Electric Trains

M.T.H.

ELECTRIC TRAINS, INC.

7020 Columbia Gateway Drive
Columbia, MD 21046-1532

www.mth-railking.com



Now the passengers on your layout can act as realistic as your trains. When the RailKing® Operating Passenger Platform is connected to the activation button or to an ITAD, its passengers "board" their train when it stops at the station, leaving behind empty platforms when the train departs. The secret to the empty platforms is a design that hides the passengers under the roof of the platform, so that they appear to have boarded the train.

It will be easy to surprise friends and family with the Operating Passenger Platform when you follow the directions inside.

Operating Passenger Platform

CAUTION: ELECTRICALLY OPERATED PRODUCT:

Not recommended for children under 8 years of age without adult supervision. As with all electric products, precautions should be observed during handling and use to reduce the risk of electric shock.

WARNING: When using electrical products, basic safety precautions should be followed including the following:

- Read this manual thoroughly before using this device.
- M.T.H. recommends that all users and persons supervising use examine the unit periodically for conditions that may result in the risk of fire, electric shock, or injury to persons, such as damage to the primary cord, plug blades, housing, output jacks or other parts. In the event such conditions exist, the units should not be used until properly repaired.
- This unit is intended for indoor use. Do not use if water is present. Serious injury or fatality may result.
- Do not operate with damaged wires or clips.
- Do not use this unit for other than its intended purpose. This unit was designed to operate with any AC or DC output toy train transformer. See the transformer's operating instructions for more operating and safety information.

Passenger Station Platform

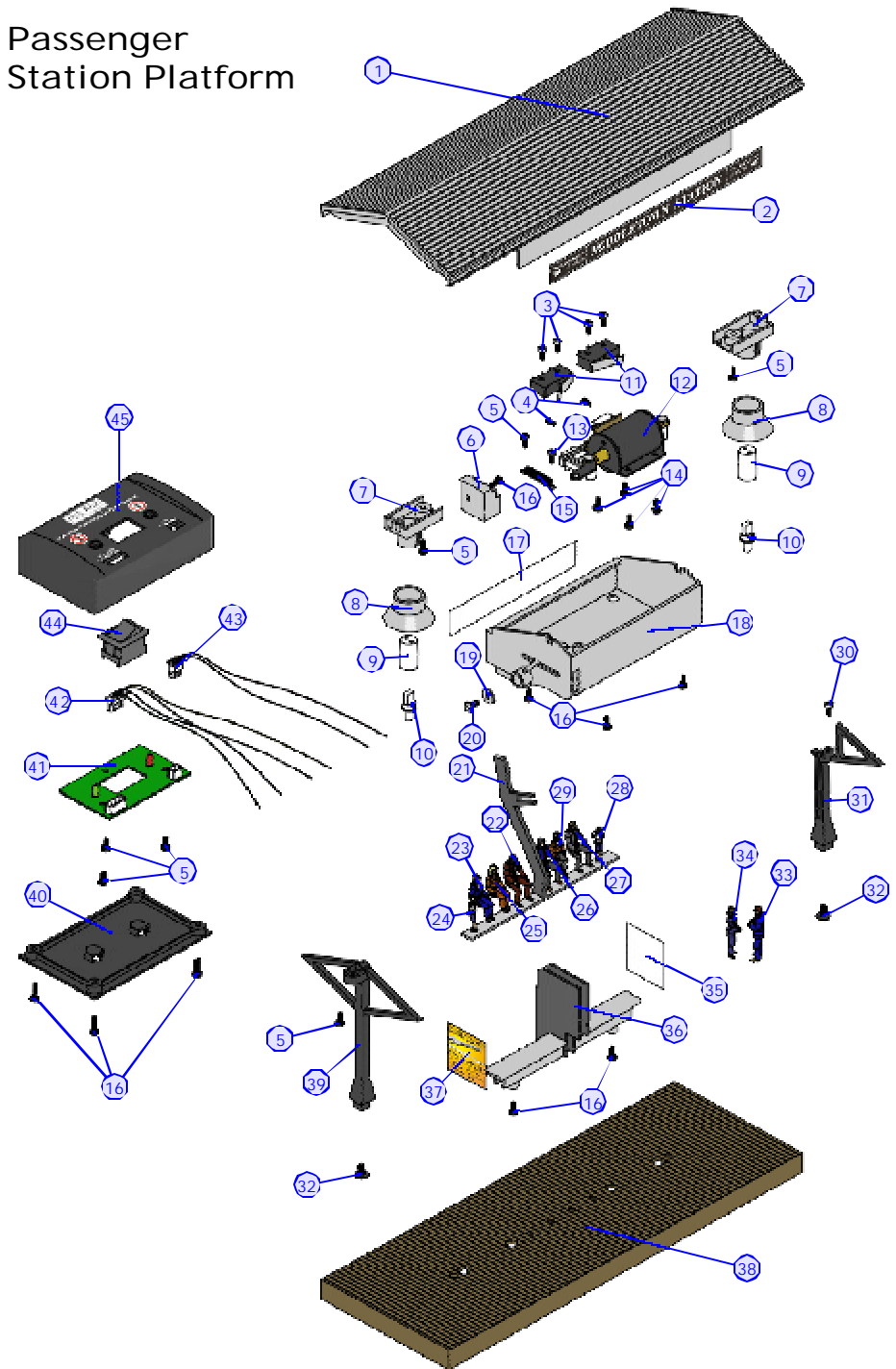

Passenger Station Platform

Parts

Name and Number	Part #
1.) Roof	HH-5200043
2.) Sign (Middletown Station) (To Lowertown 605 Miles & To Uppertown 337 Miles)	HH-5200044
3.) Screw (M2.3X10.0mm) (roundhead)(plastic cutting threads)	IA-0000283
4.) Screw (M2X3.0mm)(roundhead)	IA-0000018
5.) Screw (M2.6X6.0mm) (roundhead)(plastic cutting threads)	IA-0000206
6.) Weight	II-5200001
7.) Light holder	HH-5200045
8.) Light shade	HH-5200046
9.) Light socket (w/ wires)	CH-0000031
10.) Bulb (12V)(grain of wheat)	CG-0000017
11.) Switch (micro)	BB-0000021
12.) Solenoid (complete)	BE-0000053
13.) Screw (M2.5X4.0mm)(roundhead)	IA-0000023
14.) Screw (M2.5X5.0mm)(roundhead)	IA-0000044
15.) Spring (3.6X20.0mm) (2 eyelets on each end)(0.3mm thick wire)	IE-0000049
16.) Screw (M2.6X8.0mm) (roundhead)(plastic cutting threads)	IA-0000272
17.) Sign (Middletown Station) (MTH Transit, clock face)	HH-5200047
18.) Solenoid cover (complete)	HH-5200048
19.) Washer (3.2X9.8X0.7mm)	ID-0000083
20.) Screw (M2.6X8.0mm) (washer head)(plastic cutting threads)	IA-0000281
21.) Lever (for people)	HH-5200049
22.) Sitting man (dark gray w/ hat)	HH-5200050
23.) Sitting woman (black, brown & white w/ red hat)	HH-5200051
24.) Standing girl (light blue & white)	HH-5200052
25.) Sitting woman (blue)	HH-5200053
26.) Sitting man (dark blue & white)	HH-5200054
27.) Sitting man (brown)	HH-5200055
28.) Standing boy (brown & gray)	HH-5200056
29.) Sitting woman (green)	HH-5200057
30.) Screw (M2.5X6.0mm)(roundhead)	IA-0000185
31.) Roof support (half)	HH-5200058
32.) Screw (M3X5.0mm)(washer head)	IA-0000216
33.) Standing man (black)	HH-5200059
34.) Standing woman (red & black)	HH-5200060
35.) Sign (Rail Town Hardware Store)	HH-5200061
36.) Bench seats & sign holder	HH-5200062

Name and Number	Part #
37.) Sign (MTH Railways)	HH-5200063
38.) Platform base	HH-5200064
39.) Roof support	HH-5200065
40.) Control box bottom	HH-5200066
41.) PCB control board (w/ red & green L.E.D.s)	BB-0000024
42.) Wire harness (4 pin plug) (yellow, white, blue & green wires)	BC-0000043
43.) Wire harness (2 pin plug) (red & black wires)	BC-0000044
44.) Switch	BB-0000025
45.) Control box	HH-5200067

*Requires Exchange

WIRING INSTRUCTIONS

The RailKing Operating Passenger Platform is made up of two components: the platform and the switch. Before you place the platform on the layout, you must wire it to the switch and power source. There are two ways you can do this: hook the platform to the switch or hook the platform to an Infrared Track Activation Device (ITAD sold separately). The Operating Passenger Platform needs 14-16 volts to operate.

Note: This unit is equipped with a safety device to prevent overheating. If the platform is operated at less than 14 volts, the swing can become stuck in the in-between cycle, causing the coil to overheat. The safety device will shut the unit down to prevent this. If this happens, turn off power to the operating passenger platform for 10 minutes. Then the platform will be ready to operate again at 14-16 volts.

Option 1

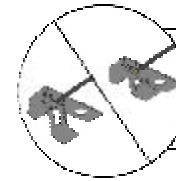

Strip Z-wire cable harness insulation to reveal 1/4" of bare wire.

From 4 Pin Connector

- A** Connect Green wire to terminal A
- B** Connect Blue wire to terminal B
- C** Connect White wire to terminal C
- D** Connect Yellow wire to terminal D

From 2 Pin Connector

- Connect Black wire to AC Ground
- Connect Red wire to AC Hot

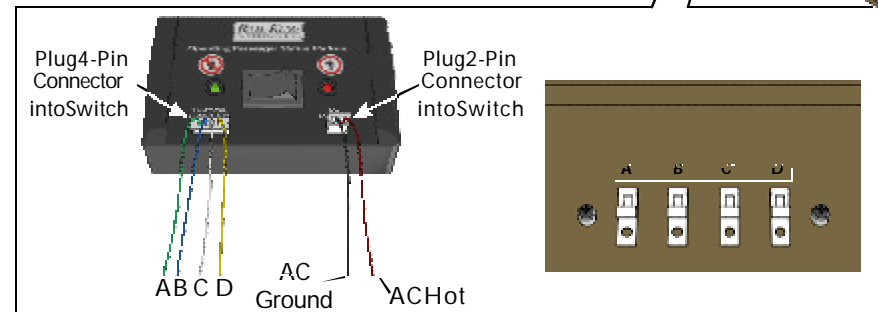
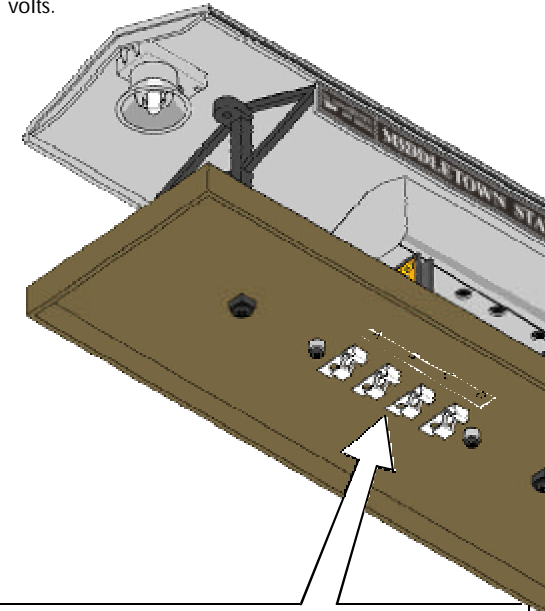
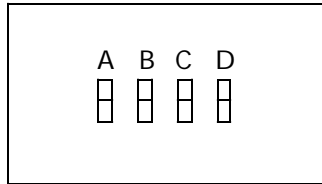

Fig1. Wiring Diagram

To operate when the platform is disconnected to the switch: Simply flip the switch whenever you want to move the people. The red light indicates that the people are down, waiting to board the train, and the green light indicates that the people are tucked under the roof, not visible on the platform.

Option 2

Connecting the platform to an ITAD: Connect the wires from under the platform to the track and ITAD as shown below. If you choose this option, you will not use the included switch.



Underside of Passenger Platform

- A Outer Rail (Transformer AC GROUND)
- B ITAD- N.O. (Normally OPEN)
- C ITAD -N.C. (Normally CLOSED)
- D Center Rail (Transformer AC HOT)

To operate when the platform is disconnected to an ITAD: Be sure the ITAD is set to track power and in a location where the train will activate it when the people should board. You should also set the ITAD for a 10-15 second delay after the train has moved past it, so that people viewing the layout have time to see that the people are gone after the train pulls away. You may want to adjust the sensitivity of the ITAD to work best with the distance of the train and operators on your layout.

M.T.H. suggests the layout shown in the diagram below as one option when using an ITAD:

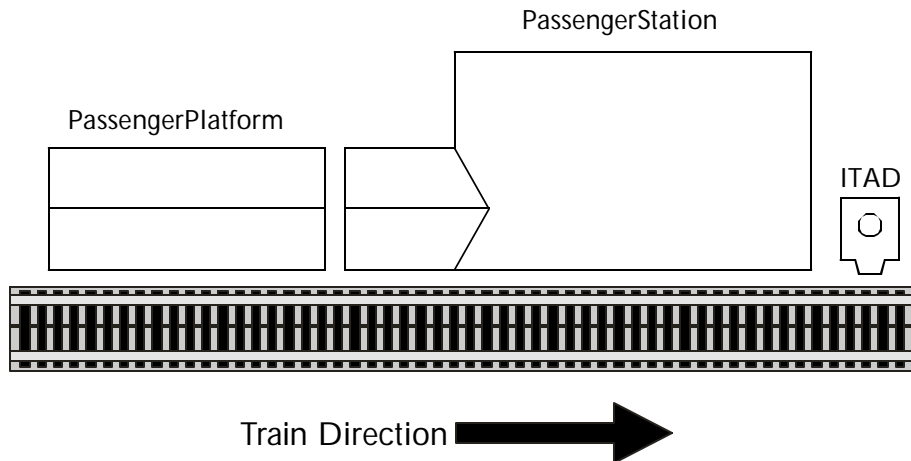

Changing the Light Bulbs: When the lights under the roof of the platform burn out, replace them by popping the old one out and then the new one back in like Christmas tree lights. You can obtain replacement bulbs directly from the M.T.H. Parts Department (phone: 410-381-2580; e-mail: parts@meth-railking.com; mail: 7020 Columbia Gateway Drive, Columbia MD 21046-1532).

